

## Compact Pilot Controlled Regulators

### Material Specifications

Body & pilot cap	Zinc
Piston, valve poppet, & collar	Plastic
Seals	Nitrile
Springs	Steel

### Repair and Service Kits

Seat Insert kit	<b>PS713P</b>
2" dial face 60 psig (0 to 4.1 bar), gauge	<b>K4520N14060</b>
2" dial face 160 psig (0 to 11.0 bar), gauge	<b>K4520N14160</b>
2" dial face 300 psig (0 to 20.7 bar), gauge	<b>K4520N14300</b>
1-3/4" digital round face 160 psig (0 to 11.0 bar), gauge	<b>K4517N14160D</b>
Mounting bracket kit (includes panel mount nut)	<b>PS707P</b>
Panel mount nut, plastic	<b>P04082</b>
Panel mount nut, metal	<b>P04079B</b>
Pilot conversion kit – relieving	<b>PS745P</b>
Non-Relieving	<b>PS747P</b>
Relieving	<b>PS749P</b>

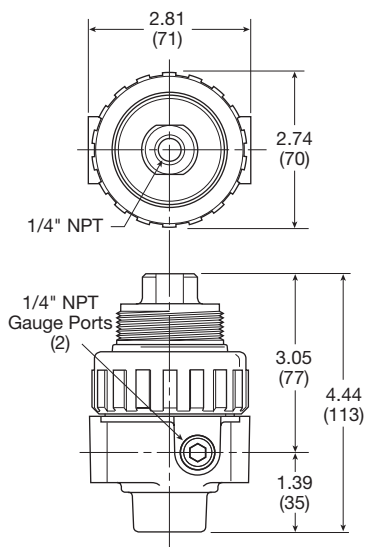

Inches (mm)

## Regulator Products

### Flow Charts

#### 1/2" Regulator

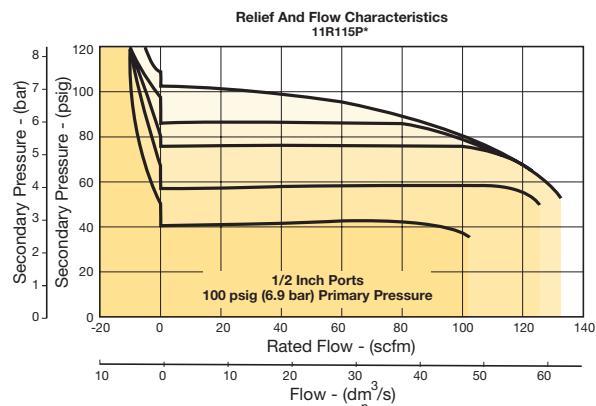

#### 3/8" Regulator

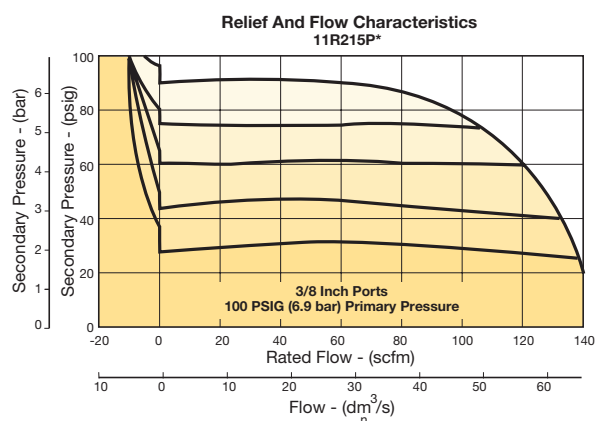

### WARNING

Product rupture can cause serious injury.  
Do not connect regulator to bottled gas.  
Do not exceed Maximum primary pressure rating.



For inventory, lead times, and kit

K51

Parker Hannifin Corporation  
Pneumatic Division

General

Dial

Pilot

Proportional

Precision

Water

K

Regulator  
Products

## 12R Pilot Controlled Regulator – Standard

- Balanced poppet provides quick response and accurate pressure regulation
- Pilot controlled regulators can be mounted “out of reach” with pilot regulator installed in a convenient location
- Solid control piston for extended life
- Two full flow 1/4" gauge ports can be used as additional outlets
- Pilot port 1/4 Inch
- 1/2", 3/4" ports (NPT, BSPP, BSPT)

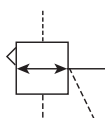

Port Size	Description	Part Number
1/2"	Without Gauge	<b>12R315PB</b>
1/2"	With 160 psi Gauge	<b>12R321PB</b>
3/4"	Without Gauge	<b>12R415PB</b>
3/4"	With 160 psi Gauge	<b>12R421PB</b>

NOTE: 2.0 Dia. (51 mm) hole required for panel mounting.

### Operating information

Supply pressure (max): 0 to 250 psig (0 to 17.2 bar)

Operating temperature: 32°F to 175°F (0°C to 80°C)

Flow capacity†:

High flow	1/2"	140 scfm (66 dm³/s, ANR)
	3/4"	140 scfm (66 dm³/s, ANR)

Gauge ports (2): 1/4 inch  
(can be used as additional full flow 1/4 inch outlet ports)

Weight: 2.0 lb (0.91 kg)

† scfm = Standard cubic feet per minute at 100 psig inlet, 90 psig no flow secondary setting and 10 psig pressure drop.

### Ordering Information:

<b>12R</b>	<b>3</b>	<b>15</b>	<b>P</b>	<b>B</b>	
<b>Port Threads</b> 1/2 inch 3 3/4 inch 4		<b>Relief / Gauge Options</b> Without Gauge Non-Relieving Piston 14 Relieving Piston 15 With Gauge * Non-Relieving Piston 19 Relieving Piston 21		<b>Port Type</b> Blank NPT 1 BSPP 2 BSPT	
				<b>Engineering Level</b> B Current	
				<b>Adjustment</b> P Pilot Operated	

\* Includes 2" dial face gauge 0 to 300 psig.

Most popular.



For inventory, lead times, and kit

K52

Parker Hannifin Corporation  
Pneumatic Division